

5B/A00 FLOOR PLAN - 1ST FLOOR
3/16"=1'-0"

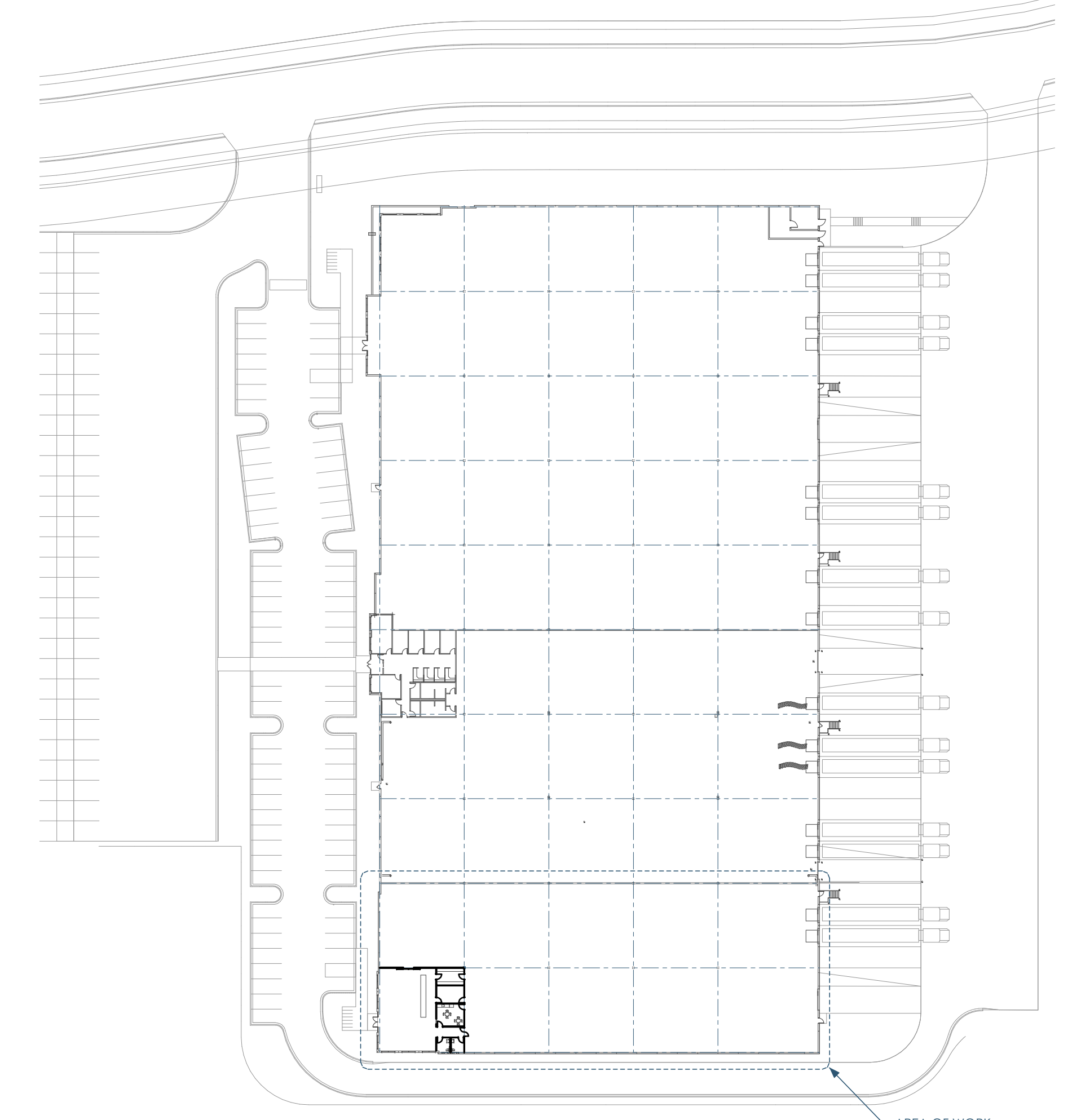

2B/A00 SITE PLAN
1/64"=1'-0"

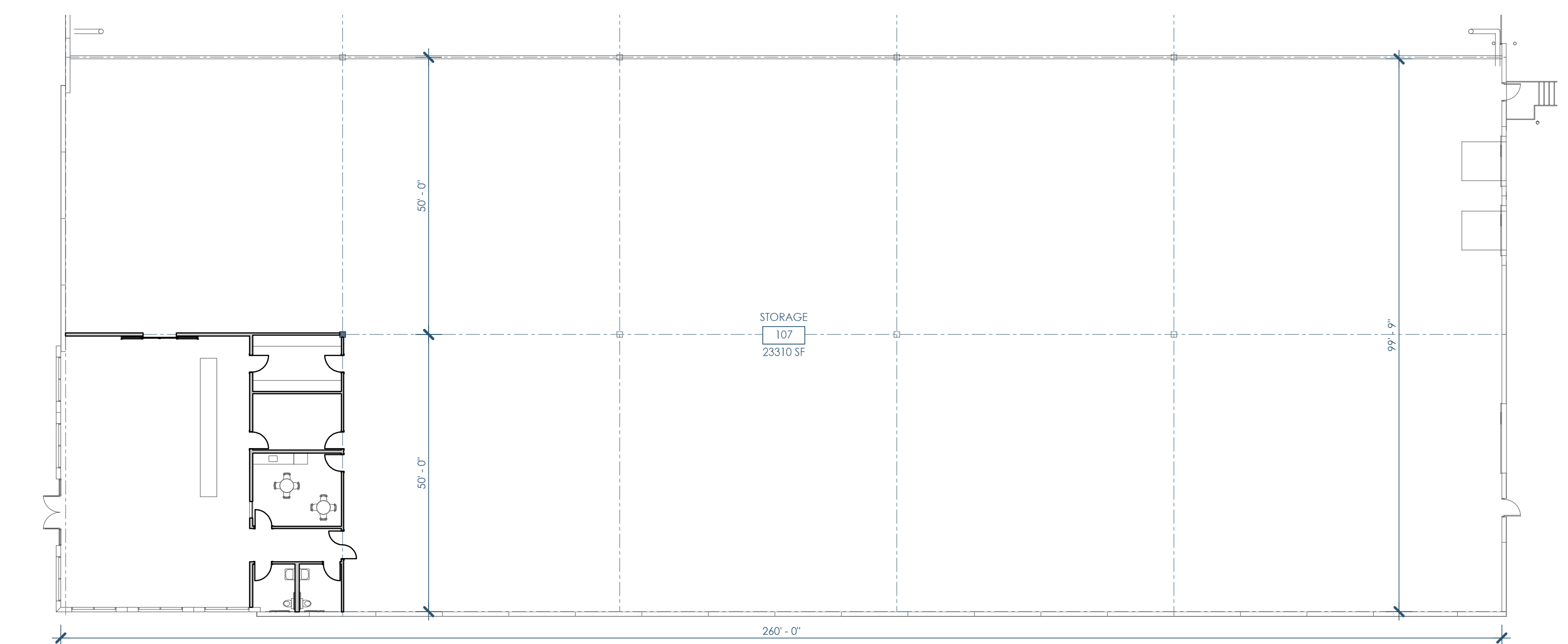

3A/A00 FLOOR PLAN - ENLARGED - 1ST FLOOR
1/16"=1'-0"



Owner: All Surfaces
5525 Tradesmen Dr
Madison, WI 53718
allsurfaces.com | 952.884.6033



GC: Lake Country Construction Group
161 Horizon Dr
Verona, WI 53593
608.845.1398



openingdesign

Architect: Opening Design
17 S Fairchild | FL 7
Madison, WI 53703
ryan@openingdesign.com | 773.425.6456

FLOOR & SITE PLAN 03/25/2024

ALL SURFACES

5525 TRADESMEN DR, MADISON, WI 53718

A00

This project, like most Opening Design's projects, is open source (Attribution-ShareAlike 4.0 International-CC BY-SA 4.0)-freely available to any party for future use, assuming the terms such as Attribution and ShareAlike are honored.