

5B/A101 FLOOR PLAN - 1ST FLOOR  
3/8"=1'-0"



2C/A101 RENDERING 1  
1/8"=1'-0"



2B/A101 RENDERING 2  
1/8"=1'-0"

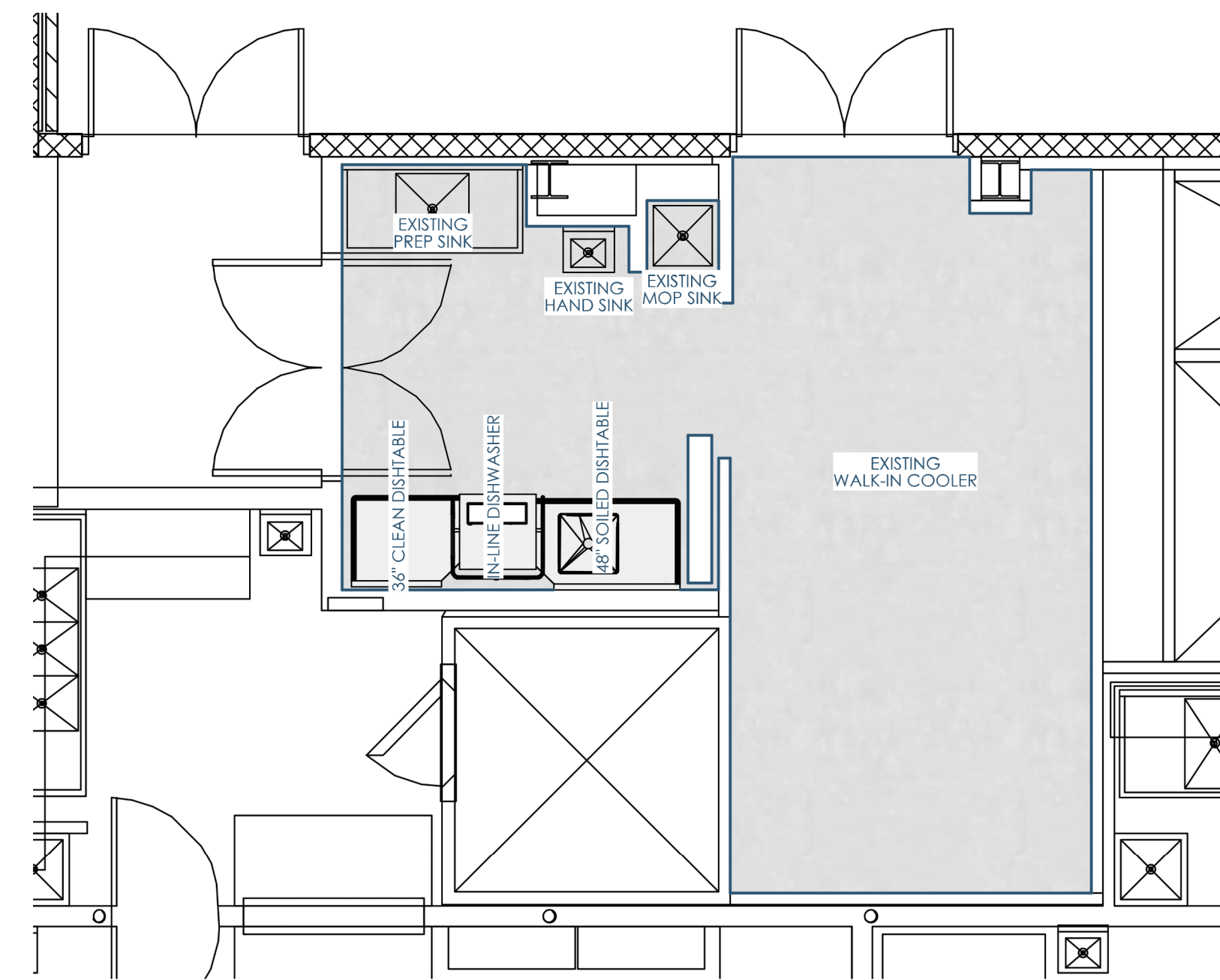

5A/A101 FLOOR PLAN - 1ST FLOOR-PREP  
1/4"=1'-0"

TYPE MARK	CATEGORY	MANUFACTURER	PRODUCT	COLOR	FINISH	LOCATION	NOTES
CON - 1	CONCRETE	-	EXISTING	-	-	-	REFINISH & RESEAL EXISTING CONCRETE
FRP - 2	FIBRE-REINFORCED PLASTIC	TBD	TBD	BLACK	-	BEHIND DIE WALL	-
PL - 1	PLASTIC LAMINATE	FORMICA	8908	STORM TEAKWOOD	-	CABINETS	-
PL - 2	PLASTIC LAMINATE	NEVAMAR	WM2640	PLANETREE MAPLE	-	SHELVES, CEILING PANELS & DIE WALL	-
PL - 4	PLASTIC LAMINATE	TBD	TBD	TBD	-	TENANT DIVIDING WALL	-
SS-1	SOLID SURFACE	CORIAN	-	SPARKLING WHITE	-	COUNTERTOPS AROUND FRONT-OF-HOUSE & AT CABINETS	-
T - 2	TILE	IRIS CERAMICA	BE IN	ROSE	GROUT (MAPEI) - 5093 WARM GRAY	FRONT-OF-HOUSE DIEWALL	-
T - 3	TILE	IRIS CERAMICA	BE IN	DECOR ROSE	GROUT (MAPEI) - 5093 WARM GRAY	FRONT-OF-HOUSE DIEWALL	-
T - 4	TILE	IRIS CERAMICA	BLAZE	AVIO & DECOR AVIO	-	FRONT-OF-HOUSE DIEWALL - ACCENT - SEE ELEVATIONS	-
WB - 1	RESILIENT FLOORING	JOHNSONITE	4" VINYL WALL	63 - BURNT UMBER B	-	FRONT-OF-HOUSE - BACK WALL	APPLIED HORIZONTALLY - SEE URL FOR PATTERN PRECEDENT
WD - 2	WOOD PANELING	SURFACING SOLUTIONS	PROFILE T678	MAPLE	CLEAR POLYURETHANE (SATIN)	FRONT-OF-HOUSE DIEWALL	-

3A/A101 FINISH KEY



openingdesign

Architect: OpeningDesign  
17 S Fairchild | FL 7  
Madison, WI 53703  
ryan@openingdesign.com | 773.425.6456

FLOOR PLANS 08/28/2024  
FK - MILWAUKEE PUBLIC MARKET  
400 N WATER ST, MILWAUKEE, WI 53202

A101

This project, like most OpeningDesign's projects, is open source (Attribution-ShareAlike 4.0 International--CC-BY-SA 4.0)--freely available to any party for future use, assuming the terms such as Attribution and ShareAlike are honored.