

RENOVATION
Phragmites
 Engineers

Owner: Renovation Wranglers
 102 E 26th St
 Bryan, TX 77803
 kate@renovations.com | 979.450.9969

ARCHITECTURE
 Architect of Record: UKB Architecture
 2929 Allen Pkwy Suite 200
 Houston, TX 77019
 isa@ukbarchitecture.com | 713.425.3076

DUDDLEY
 STRUCTURAL
 Firm # 18677
 6102 Imperial Loop Drive
 College Station, TX 77845
 corieka@dudleyeng.com | (979) 777-0720

amc
 ENGINEERS
 MEP: AMC Engineers
 Texas Firm #941
 508 E Jackson St # 552
 Burnet, TX 78611
 info@amcengineers.com | 512.535.6427

This project, like most OpeningDesign's projects, is open source. (Attribution-ShareAlike 4.0 International)-CC BY-SA 4.0- is freely available to any party for future use, assuming the terms such as Attribution and ShareAlike are honored.

8/28/2020 BXUV/U341 | UL Product IQ

UL Product IQ™

BXUV.U341

Design/System/Construction/Assembly Usage Disclaimer

- Authorities Having Jurisdiction should be consulted in all cases as to the particular requirements covering the installation and use of UL Certified products, equipment, system, devices, and materials.
- Authorities Having Jurisdiction should be consulted before construction.
- Fire resistance assemblies and products are developed by the design submitter and have been investigated by UL for compliance with applicable requirements. The published information cannot always address every construction nuance encountered in the field.
- When field issues arise, it is recommended the first contact for assistance be the technical service staff provided by the product manufacturer noted for the design. Users of fire resistance assemblies are advised to consult the general Guide Information for each product category and each group of assemblies. The Guide Information includes specifics concerning alternate materials and alternate methods of construction.
- Only products which bear UL's Mark are considered Certified.

BXUV - Fire Resistance Ratings - ANSI/UL 263 Certified for United States

BXUV7 - Fire Resistance Ratings - CAN/ULC-S101 Certified for Canada

See General Information for Fire-Resistance Ratings - ANSI/UL 263 Certified for United States Design Criteria and Allowable Variations

See General Information for Fire-Resistance Ratings - CAN/ULC-S101 Certified for Canada Design Criteria and Allowable Variations

Design No. U341
 August 19, 2020

Bearing Wall Rating — 1 Hr.
Finish Rating — Min 20 min.

This design was evaluated using a load design method other than the Limit States Design Method (e.g., Working Stress Design Method). For jurisdictions employing the Limit States Design Method, such as Canada, a load restriction factor shall be used — See Guide BXUV or BXUV7

*** Indicates such products shall bear the UL or cUL Certification Mark for jurisdictions employing the UL or cUL Certification (such as Canada), respectively.**

<https://iq.ulprospector.com/en/profile?e=14916> 1/8

8/28/2020 BXUV/U341 | UL Product IQ

surface of Classified veneer baseboard with joints reinforced with paper tape.

4. **Sheathing** — (Optional) — Septum may be sheathed with min 7/16 in. thick wood structural panels min grade "C-D" or "Sheathing" or min 1/2 in. thick **Mineral and Fiber Boards***.
 See **Mineral and Fiber Boards** (CER2) category for names of Classified companies.

5. **Batts and Blankets*** — 3-1/2 in. max thickness glass or mineral fiber batt insulation. **Optional** when sheathing (Item 4) is used on both halves of wall.
 See **Batts and Blankets** (BZJ2) category for list of Classified companies.

5A. **Fiber, Sprayed*** — As an alternate to Batts and Blankets (Item 5) — Spray applied cellulose material. The fiber is applied with water to completely fill the enclosed cavity in accordance with the application instructions supplied with the product with a nominal dry density of 2.7 lb/ft³. Alternate Application Method: The fiber is applied without water or adhesive at a nominal dry density of 3.5 lb/ft³ in accordance with the application instructions supplied with the product.
U'S GREENFIBER L L C — IN573S, IN574S and IN576LD for use with wet or dry application. IN5515LD, IN5541D, IN575S, IN576LD, and IN577LD are to be used for dry application only.

5B. **Fiber, Sprayed*** — As an alternate to Batts and Blankets (Item 5) when Sheathing (Item 4) is used on both halves of wall - Spray applied cellulose insulation material. The fiber is applied with water to interior surfaces in accordance with the application instructions supplied with the product. Applied to completely fill the enclosed cavity. Minimum dry density of 4.3 pounds per cubic ft.
NU-WOOL CO INC — Cellulose Insulation

5C. **Batts and Blankets*** — (Required for use with Wall and Partition Facings and Accessories, Item 2A. Use of Sheathing, Item 4, does not nullify requirement of Item 5C for use with Item 2A) — Glass fiber insulation, nom 3-1/2 in. thick, min. density of 0.80 pcf, with a flame spread of 25 or less and a smoke developed of 50 or less, friction-fitted to completely fill the stud cavities. See Batts and Blankets Category (BKNV) for names of manufacturers.

5D. **Fiber, Sprayed*** — As an alternate to Batts and Blankets (Item 5) and Item 5A when Sheathing (Item 4) is used on both halves of wall - Spray applied cellulose fiber. The fiber is applied with water to completely fill the enclosed cavity in accordance with the application instructions supplied with the product. The minimum dry density shall be 4.30 lbs/ft³.
INTERNATIONAL CELLULOSE CORP — Cellar-It

5E. **Fiber, Sprayed*** — As an alternate to Batts and Blankets (Item 5) - Spray-applied cellulose material. The fiber is applied with water to completely fill the enclosed cavity in accordance with the application instructions supplied with the product. To facilitate the installation of the material, any thin, woven or non-woven netting may be attached by any means possible to the outer face the studs. The material shall reach equilibrium moisture content before the installation of materials on either face of the studs. The minimum dry density shall be 5.79 lbs/ft³.
APPLAGATE HOLDINGS L L C — Applagate Advanced Stabilized Cellulose Insulation

<https://iq.ulprospector.com/en/profile?e=14916> 5/8

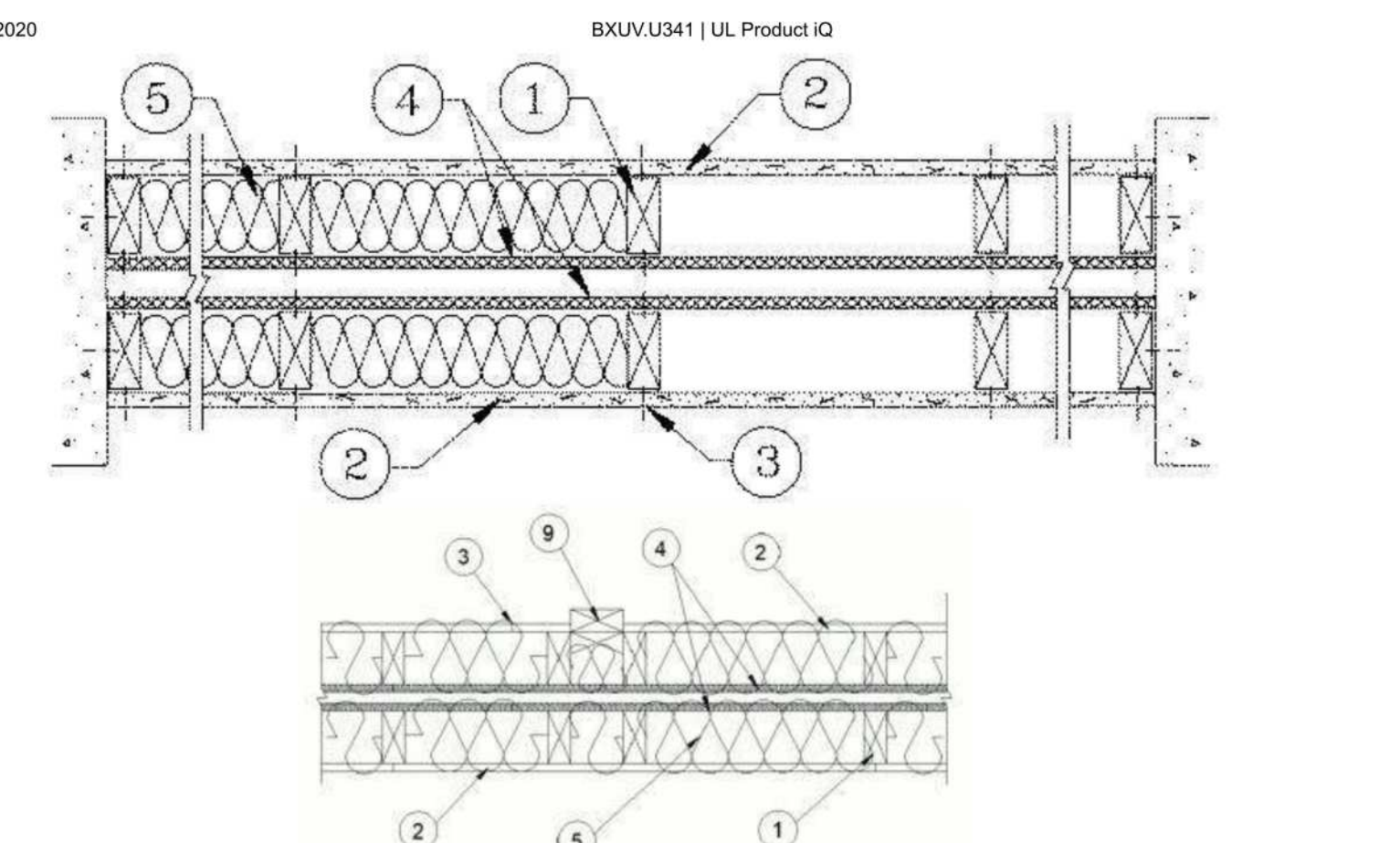

HORIZONTAL SECTION

1. **Wood Studs** — Nom 2 by 4 in., spaced 24 in. OC, max. Cross braced at mid-height and effectively firestopped at top and bottom of wall. No min. air space between stud rows except to accommodate attachment of sheathing, where required. See Items 4 and 5.

2. **Gypsum Board*** — Any 5/8 in. thick UL Classified Gypsum Board that is eligible for use in Design Nos. L501, G512 or U305. Nom 5/8 in. thick 4 ft wide. Gypsum board applied horizontally or vertically, unless specified below, and nailed to studs and bearing plates 7 in. OC with 6d cement coated nails, 1-7/8 in. long, 0.0915 in. shank diam and 1/4 in. diam head. As an alternate, No. 6 bugle head drywall screws, 1-7/8 in. long, may be substituted for the 6d cement coated nails.
 When **Steel Framing Members*** (Item 6-C) are used, wallboard attached to furring channels with 1 in. long Type 5 bugle-head steel screws spaced 12 in. OC.
 When used in widths other than 48 in., gypsum board to be installed horizontally.

AMERICAN GYPSUM CO (View Classification) — CNKX.R14196

BEIJING NEW BUILDING MATERIALS PUBLIC LTD CO (View Classification) — CNKX.R19374

CABOT MANUFACTURING ULC (View Classification) — CNKX.R25370

CERTAINTED GYPSUM INC (View Classification) — CNKX.R3660

CSC INC (View Classification) — CNKX.R19751

CONTINENTAL BUILDING PRODUCTS OPERATING CO, L L C (View Classification) — CNKX.R18482

GEORGIA-PACIFIC GYPSUM L L C (View Classification) — CNKX.R2717

LOADMASTER SYSTEMS INC (View Classification) — CNKX.R1809

<https://iq.ulprospector.com/en/profile?e=14916> 2/8

8/28/2020 BXUV/U341 | UL Product IQ

fitted into clips. RSIC-1 clip for use with 2-9/16 in. wide furring channels. RSIC-1 (2.75) clip for use with 2-23/32 in. wide furring channels.
PAC INTERNATIONAL L L C — Types RSIC-1, RSIC-1 (2.75).

6A. **Steel Framing Members*** — (Optional, Not Shown) — Furring channels and Steel Framing Members as described below:
 a. **Furring Channels** — Formed of No. 25 MSG galv steel, 2-3/8 in. wide by 7/8 in. deep, spaced 24 in. OC perpendicular to studs. Channels secured to studs as described in Item b. Ends of adjoining channels are overlapped 6 in. and tied together with double strand of No. 18 SWG galv steel wire near each end of overlap. As an alternate, ends of adjoining channels may be overlapped 6 in. and secured together with two self-tapping #6 framing screws, min. 7/16 in. long at the midpoint of the overlap, with one screw on each flange of the channel. Gypsum board attached to furring channels as described in Item 2.
 b. **Steel Framing Members*** — Used to attach furring channels (Item a) to studs. Clips spaced 48 in. OC. Genie clips secured to studs with No. 8 x 1-1/2 in. coarse drywall screw through the center hole. Furring channels are friction fitted into clips.
PLITEQ INC — Type Genie Clip

6B. **Steel Framing Members*** — (Optional, Not Shown) — Furring channels and Steel Framing Members as described below:
 a. **Furring Channels** — Formed of No. 25 MSG galv steel, Spaced 24 in. OC perpendicular to studs. Channels secured to studs as described in Item b. Ends of adjoining channels overlapped 6 in. and tied together with double strand of No. 18 AWG galvanized steel wire. Gypsum board attached to furring channels as described in Item 2.
 b. **Steel Framing Members*** — Used to attach furring channels (Item 6Ba) to studs. Clips spaced 48 in. OC, and secured to studs with 2 in. coarse drywall screw with 1 in. diam washer through the center hole. Furring channels are friction fitted into clips.
STUDDO BUILDING SYSTEMS — RESILMOUNT Sound Insulation Clips - Type A237R

6C. **Steel Framing Members*** — (Optional, Not Shown) — Furring channels and Steel Framing Members as described below:
 A. **Furring Channels** — Formed of No. 25 MSG galv steel, Spaced 24 in. OC perpendicular to studs. Channels secured to studs as described in Item 6Cb. Ends of adjoining channels overlapped 6 in. and tied together with double strand of No. 18 AWG galvanized steel wire. Gypsum board attached to furring channels as described in Item 2.
 B. **Steel Framing Members*** — Used to attach furring channels (Item 6Ca) to studs. Clips spaced 48 in. OC, and secured to studs with No. 8 x 2-1/2 in. coarse drywall screw through the center hole. Furring channels are friction fitted into clips.
REGUPOUL AMERICA — Type SonusClip

6D. **Steel Framing Members*** — (Optional, Not Shown) — Resilient channels and Steel Framing Members as described below:
 a. **Resilient Channels** — Formed of No. 25 MSG galv steel, spaced 24 in. OC, and perpendicular to studs. Channels secured to studs as described in Item b. Ends of adjoining channels overlapped 6 in. and secured in place with two No. 8 15 x 1/2 in. Phillips Modified Truss screws spaced 2-1/2 in. in. from the center of the overlap. Gypsum board attached to resilient channels as described in Item 2.
 b. **Steel Framing Members*** — Used to attach resilient channels (Item 6Da) to studs. Clips spaced 48 in. OC, and secured to studs with No. 8 x 2-1/2 in. coarse drywall screw through the center hole. Resilient channels are secured to clips with one No. 10 x 1/2 in. pan-head self-drilling screw.
KEENE BUILDING PRODUCTS CO INC — Type RC+ Assurance Clip

<https://iq.ulprospector.com/en/profile?e=14916> 6/8

8/28/2020 BXUV/U341 | UL Product IQ

NATIONAL GYPSUM CO (View Classification) — CNKX.R3501

PABCO BUILDING PRODUCTS L L C, DBA PABCO GYPSUM (View Classification) — CNKX.R37094

PANEL REY S A (View Classification) — CNKX.R21796

SIAM GYPSUM INDUSTRY (SARABURI) CO LTD (View Classification) — CNKX.R19262

THAI GYPSUM PRODUCTS PCL (View Classification) — CNKX.R27517

UNITED STATES GYPSUM CO (View Classification) — CNKX.R1319

USG BORAL DRYWALL SFZ LLC (View Classification) — CNKX.R38438

USG BORAL DRYWALL SFZ LLC (View Classification) — CNKX.R38438

USG MEXICO S A DE CV (View Classification) — CNKX.R16089

2A. **Gypsum Board*** — (As an alternate to Item 2, not shown) — Nominal 5/8 in. thick, 4 ft wide panels, applied vertically to studs and bearing plates on one side of the assembly with 1-5/8 in. long Type 5 screws spaced 12 in. OC at perimeter of panels and 8 in. OC in the field. Horizontal joints of vertically applied panels need not be backed by studs. Panel joints covered with paper tape and two layers of joint compound. Screwheads covered with two layers of joint compound. Batts and Blankets placed in stud cavity as described in Item 5C. Not evaluated for use with Steel Framing Members, Furring Channels or Fiber, Sprayed.
PABCO BUILDING PRODUCTS L L C, DBA PABCO GYPSUM — Type QuietRock QR-530 (finish rating 23 min).

2B. **Gypsum Board*** — (As an alternate to Item 2, not shown) — Any 5/8 in. thick gypsum panels that are eligible for use in Design Nos. L501, G512 or U305, supplied by the Classified companies listed below shown in the **Gypsum Board*** (CNKX) category. Applied horizontally or vertically and attached to studs and bearing plates with 1-1/4 in. long Type W coarse thread gypsum panel steel screws spaced a max 8 in. OC, with last screw 1 in. from edge of board. When used in widths other than 48 in., gypsum board to be installed horizontally.
UNITED STATES GYPSUM CO
USG BORAL DRYWALL SFZ LLC
USG MEXICO S A DE CV

2C. **Gypsum Board*** — (As an alternate to Item 2, Not Shown) — 5/8 in. thick gypsum panels applied horizontally or vertically and attached to studs and bearing plates with 1-1/4 in. long Type W coarse thread gypsum panel steel screws spaced a max 8 in. OC, with last screw 1 in. from edge of board. When used in widths other than 48 in. OC, with last screw 1 in. from edge of board. When used in widths other than 48 in., gypsum board to be installed horizontally.
AMERICAN GYPSUM CO — Types AGX-1, M-Glass, AGX-LightRoc

CERTAINTED GYPSUM INC — Type C, Type X or Type X-1

NATIONAL GYPSUM CO — Type FSK, Type FSK-G, Type FSW, Type FSW-3, Type FSW-5, Type FSW-G, Type FSK-C, Type FSW-C, Type FSMR-C, Type FSW-6, Type FSL

THAI GYPSUM PRODUCTS PCL — Type C or Type X

<https://iq.ulprospector.com/en/profile?e=14916> 3/8

8/28/2020 BXUV/U341 | UL Product IQ

6E. **Steel Framing Members*** — (Optional, Not Shown) — Used as an alternate method to attach resilient channels to wall studs. A resilient sound insulation accessory shall be used at each attachment point of the resilient channels and spaced max 24 in. O.C. Channel ends butted and centered under the structural members and attached with one accessory at each end. Additional accessories used to hold resilient channels that support the gypsum board end joints. The accessory envelops the mounting edge of the resilient channel. The accessory and resilient channel are fastened to the structural members with the screws supplied with the accessory and per the accessory manufacturer's installation instructions.
PAC INTERNATIONAL L L C — Type RC-1 Boost

7. **Wall and Partition Facings and Accessories*** — (Optional, Not shown) — Nominal 1/2 in. thick, 4 ft wide panels, for optional use as an additional layer on one or both sides of the assembly. Panels attached in accordance with manufacturer's recommendations. When the QR-500 or QR-510 panel is installed between the wood framing and the UL Classified gypsum board, the required UL Classified gypsum board layer(s) is/are to be installed as indicated as to fastener type and spacing, except that the required fastener length shall be increased by a minimum of 1/2 in. Not evaluated or intended as a substitute for the required layer(s) of UL Classified Gypsum Board.
PABCO BUILDING PRODUCTS L L C, DBA PABCO GYPSUM — Type QuietRock QR-500 and QR-510

8. **Mineral and Fiber Board*** — (Optional, Not Shown) — For optional use as an additional layer on one or both sides of wall. Nom 1/2 in. thick, 4 ft wide with long dimension parallel and centered over studs. Attached to framing as described in Item 2. The required UL Classified gypsum board layer(s) is/are to be installed as indicated as to fastener type and spacing, except that the required fastener length shall be increased by a minimum of 1/2 in. Not evaluated or intended as a substitute for the required layer(s) of UL Classified Gypsum Board.
HOMASOTE CO — Homasote Type 440-32

9. **Non-Bearing Wall Partition Intersection** — (Optional) — Two nominal 2 by 4 in. stud or nominal 2 by 6 in. stud nailed together with two 3in. long 10d nails spaced a max. 16 in. OC, vertically and fastened to one side of the minimum 2 by 4 in. stud with 3 in. long 10d nails spaced a max 16 in. OC, vertically. Intersection between partition wood studs to be flush with the 2 by 4 in. studs. The wall partition wood studs are to be framed by with a second 2 by 4 in. wood stud fastened with 3 in. long 10d nails spaced a max. 16 in. OC, vertically. Maximum one non-bearing wall partition intersection per stud cavity. Non-bearing wall partition stud depth shall be at a minimum equal to the depth of the bearing wall.

(Optional, Not Shown) Alternate Construction For Use On One Side Of The Wall.

10. **Mineral and Fiber Board*** — For use with Items 10A-10D) — Nom 1/2 in. thick, 4 ft wide with long dimension parallel and centered over studs. Attached to framing with minimum 1-3/8 in. long ring shanked nails or 1-1/4 in. long Type W steel screws, spaced 12 in. OC along board edges and 24 in. OC in field of board along intermediate framing. Not evaluated or intended as a substitute for the required layer(s) of UL Classified Gypsum Board.
HOMASOTE CO — Homasote Type 440-32

10A. **Glass Fiber Insulation** — (For use with Item 10) — 3-1/2 in. thick glass fiber batts bearing the UL Classification Marking as to Surface Burning and/or Fire Resistance, placed to fill the interior of the wall. See Batts and Blankets (BKNV or BZJ2) categories for names of Classified companies.

10B. **Batts and Blankets*** — (As an alternate to Item 10B, For use with Item 10), 3 in. thick mineral wool batts, placed to fill interior of wall, attached to the 3-1/2 in. face of the studs with staples placed 24 in. OC.
THERMAFIBER INC — Type SAFR, SAFR FF

10C. **Adhesive** — (For use with Item 10) — Construction grade adhesive applied in vertical, serpentine, nominal 3/8 in. wide beads down the length of both vertical edges of Mineral and Fiber Board (Item 14A).

<https://iq.ulprospector.com/en/profile?e=14916> 7/8

8/28/2020 BXUV/U341 | UL Product IQ

2D. **Gypsum Board*** — (As an alternate to Items 2, 2A, 2B and 2C) — 5/8 in. thick gypsum panels, with square edges, applied either horizontally or vertically. Gypsum panels fastened to framing with 1-1/4 in. long Type W coarse thread gypsum panel steel screws spaced a max 8 in. OC, with last 2 screws 1 and 4 in. from edge of board or nailed as described in Item 2. When used in widths of other than 48 in., gypsum boards are to be installed horizontally.
GEORGIA-PACIFIC GYPSUM L L C — GreenGlass Type X, Type DGG.

2E. **Gypsum Board*** — (As an alternate to Items 2 through 2D) — 5/8 in. thick, 4 ft wide, paper surfaced applied vertically only and secured as described in Item 2.
GEORGIA-PACIFIC GYPSUM L L C — Type X ComfortGuard Sound Deadening Gypsum Board.

2F. **Gypsum Board*** — (As an alternate to Items 2 through 2E) - Installed as described in Item 2, 5/8 in. thick, 4 ft wide, paper surfaced, applied vertically only and fastened to the studs and plates with 6d cement coated nails 1-7/8 in. long, 0.0915 in. shank diam and 1/4 in. diam heads, 7 in. OC. Not for use with Item #6.
NATIONAL GYPSUM CO — Type S3W8

2G. **Gypsum Board*** — (As an alternate to Items 2 through 2F) — Nominal 5/8 in. thick, 4 ft wide panels, applied vertically and secured as described in Item 2.
PABCO BUILDING PRODUCTS L L C, DBA PABCO GYPSUM — Types QuietRock ES.

2H. **Gypsum Board*** — (As an alternate to Items 2 through 2G) — Installed as described in Item 2, 5/8 in. thick, 4 ft wide, paper surfaced, applied vertically or horizontally fastened to the studs and plates with 1-1/4 in. long Type W coarse thread gypsum panel steel screws spaced a max 8 in. OC, with last screw 1 in. from edge of board.
CERTAINTED GYPSUM INC — Type SilentFX

2I. **Wall and Partition Facings and Accessories*** — (As an alternate to Items 2 through 2H) — Nominal 5/8 in. thick, 4 ft wide panels, applied vertically and secured as described in Item 2.
PABCO BUILDING PRODUCTS L L C, DBA PABCO GYPSUM — Type QuietRock S27.

2J. **Gypsum Board*** — (As an alternate to 5/8 in. Type FSW in Item 2) — 2 layers nom. 5/16 in. thick gypsum panels applied vertically or horizontally. Horizontal joints on the same side need not be staggered. Inner layer attached with fasteners, as described in Item 2, spaced 24 in. OC. Outer layer attached per Item 2.
NATIONAL GYPSUM CO — Type FSW.

2K. **Gypsum Board*** — (As an alternate to Item 2) — 5/8 in. thick gypsum panels, with beveled, square, or tapered edges, applied either horizontally or vertically. Gypsum panels fastened to framing with 1-1/4 in. long Type W coarse thread gypsum panel steel screws spaced a maximum 10 in. OC with the last two screws 4 and 1 in. from the edges of the board. When used in widths other than 48 in., gypsum panels are to be installed horizontally.
CONTINENTAL BUILDING PRODUCTS OPERATING CO, L L C — Type LGFC6A (finish rating 21 min), Type LGFC2A, Type LGFC-C/A, Type LGFC-WG, Type LGFLX

3. **Joints and Nailheads** — Gypsum board joints of outer layer covered with tape and joint compound. Nail heads of outer layer covered with joint compound. As an alternate, nom 3/32 in. thick gypsum veneer plaster may be applied to the entire

<https://iq.ulprospector.com/en/profile?e=14916> 4/8

8/28/2020 BXUV/U341 | UL Product IQ

10D. **Gypsum Board*** — (For use with Item 10) — 5/8 in. thick, 4 ft wide, applied vertically over Mineral and Fiber Board (Item 14A) with vertical joints located anywhere over stud cavities. Secured to mineral and fiber boards with 1-1/2 in. Type G Screws spaced 8 in. OC along edges of each vertical joint and 12 in. OC in intermediate field of the Mineral and Fiber Board (Item 10). Secured to outermost studs and bearing plates with 2 in. long Type 5 screws spaced 8 in. OC. Gypsum Board joints covered with paper tape and joint compound. Screw heads covered with joint compound. Finish Rating 30 Min.
AMERICAN GYPSUM CO — Type AG-C

CERTAINTED GYPSUM INC — Type C

CONTINENTAL BUILDING PRODUCTS OPERATING CO, L L C — Type LGFC-C/A

GEORGIA-PACIFIC GYPSUM L L C — Types S, DAPC, TG-C

NATIONAL GYPSUM CO — Types FSK-C, FSW-C

PABCO BUILDING PRODUCTS L L C, DBA PABCO GYPSUM — Type PG-C

PANEL REY S A — Type PRC

THAI GYPSUM PRODUCTS PCL — Type C

UNITED STATES GYPSUM CO — Type CTypes C, IP-X2, IPC-AR

USG BORAL DRYWALL SFZ LLC — Type C

USG MEXICO S A DE CV — Types C, IP-X2, IPC-AR

*** Indicates such products shall bear the UL or cUL Certification Mark for jurisdictions employing the UL or cUL Certification (such as Canada), respectively.**

Last Updated on 2020-08-19

The appearance of a company's name or product in this database does not in itself assure that products so identified have been manufactured under UL's Follow-Up Service. Only those products bearing the UL Mark should be considered to be Certified and covered under UL's Follow-Up Service. Always look for the Mark on the product.

UL permits the reproduction of the material contained in the Online Certification Directory subject to the following conditions: 1. The Guide Information, Assemblies, Constructions, Designs, Systems, and/or Certifications (files) must be presented in their entirety and in a non-misleading manner, without any manipulation of the data (or drawings); 2. The statement "Reprinted from the Online Certifications Directory with permission from UL" must appear adjacent to the extracted material. In addition, the reprinted material must include a copyright notice in the following format: © 2020 UL LLC.

<https://iq.ulprospector.com/en/profile?e=14916> 8/8

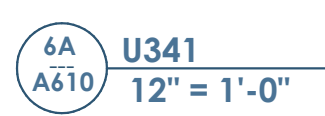

Date	Description
08/10/2022	Issued for Permit
08/26/2022	Permit Revisions

openingdesign

Architect: OpeningDesign
 17 S Fairchild | FL 7
 Madison, WI 53703
 ryan@openingdesign.com | 773.425.6456

