

5

4

3

2

1

C

B

A

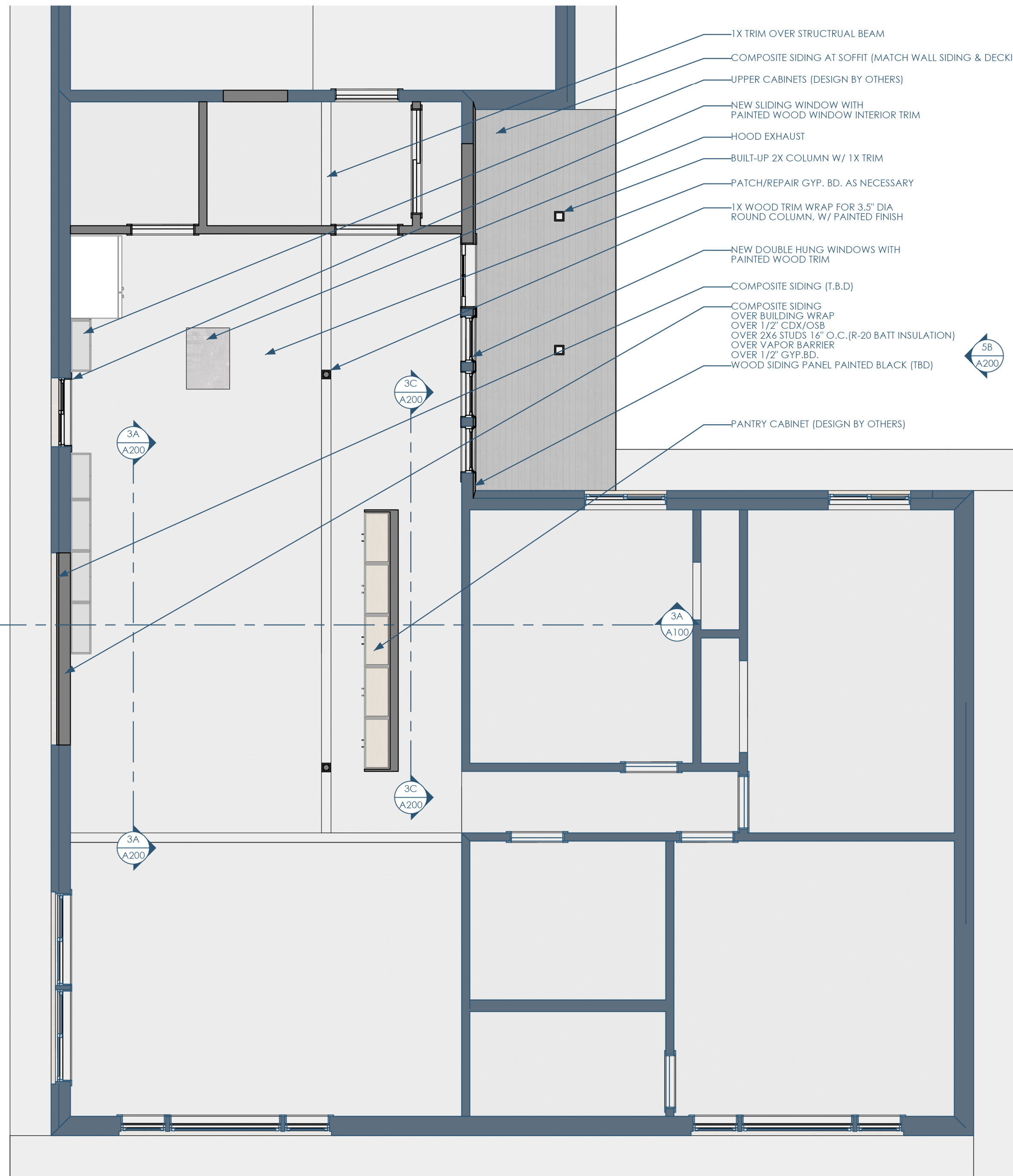

- 1X TRIM OVER STRUCTURAL BEAM
- COMPOSITE SIDING AT SOFFIT (MATCH WALL SIDING & DECKING)
- UPPER CABINETS (DESIGN BY OTHERS)
- NEW SLIDING WINDOW WITH PAINTED WOOD WINDOW INTERIOR TRIM
- HOOD EXHAUST
- BUILT-UP 2X COLUMN W/ 1X TRIM
- PATCH/REPAIR GYP. BD. AS NECESSARY
- 1X WOOD TRIM WRAP FOR 3.5" DIA. ROUND COLUMN, W/ PAINTED FINISH
- NEW DOUBLE HUNG WINDOWS WITH PAINTED WOOD TRIM
- COMPOSITE SIDING (T.B.D.)
- COMPOSITE SIDING OVER BUILDING WRAP OVER 1/2" CDX/OSB OVER 2X6 STUDS 16" O.C. (R-20 BATT INSULATION) OVER VAPOUR BARRIER OVER 1/2" GYP.BD. WOOD SIDING PANEL PAINTED BLACK (TBD)
- PANTRY CABINET (DESIGN BY OTHERS)

5A/A300 RCP - 1ST FLOOR
1/4"=1'-0"

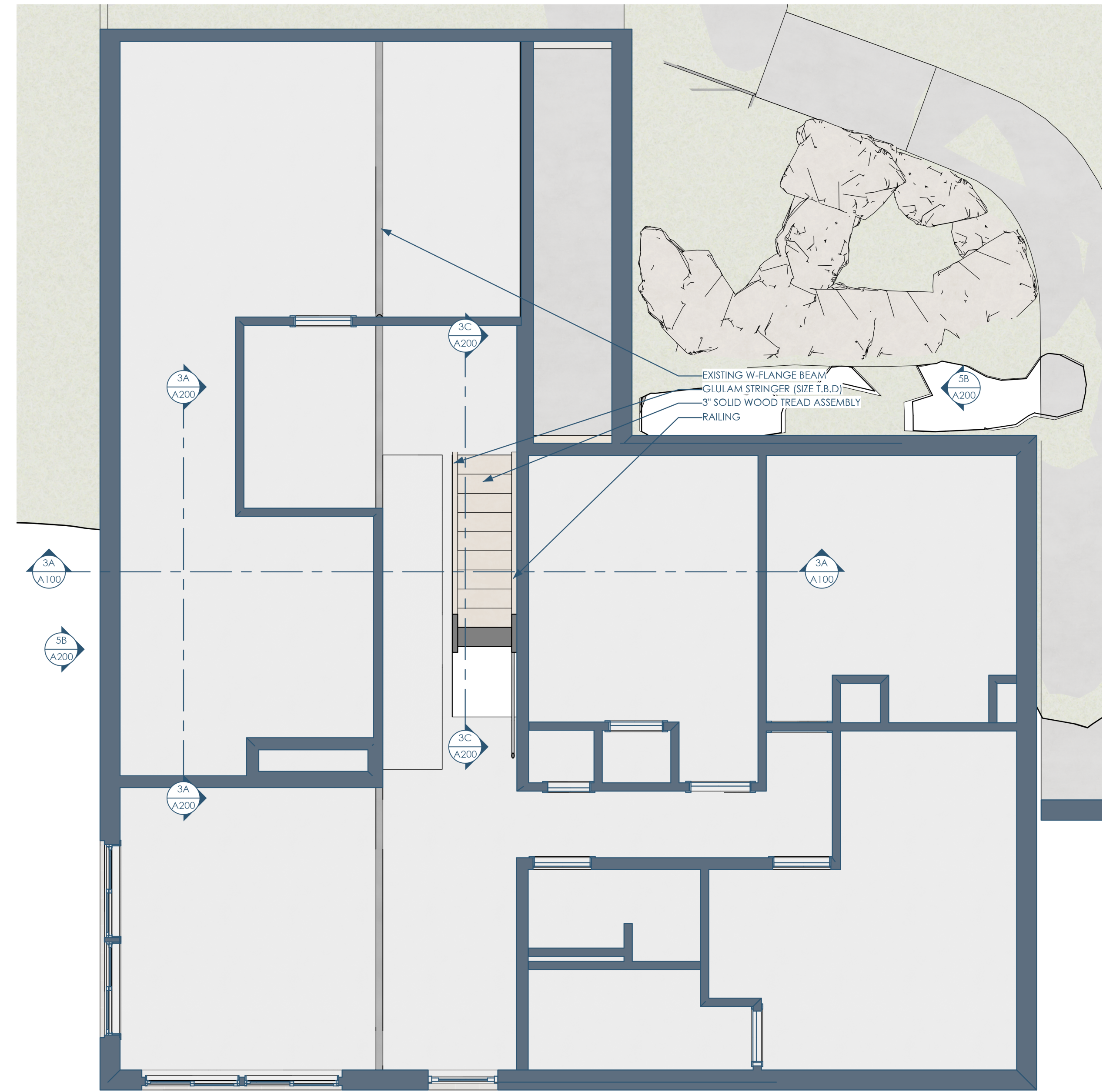

3A/A300 RCP - BASEMENT
1/4"=1'-0"

- EXISTING W-FLANGE BEAM
- GULAM STRINGER (SIZE T.B.D.)
- 3" SOLID WOOD TREAD ASSEMBLY
- RAILING



Architect: OpeningDesign
 17 S Fairchild | FL 7
 Madison, WI 53703
 ryan@openingdesign.com | 773.425.6456

RCP PLANS
 LAKE KEGONSA RESIDENCE

A300

5

4

3

2

1

This project, like most OpeningDesign's projects, is open source (Attribution-ShareAlike 4.0 International=CC-BY-SA 4.0) - freely available to any party for future use, assuming the terms such as Attribution and ShareAlike are honored.